

HydroSure™

IRRIGATION SYSTEMS THAT WORK

150m Heavy Duty Hose Cart with Basket

www.hydrosure.com

100205189



COMPONENTS INCLUDED

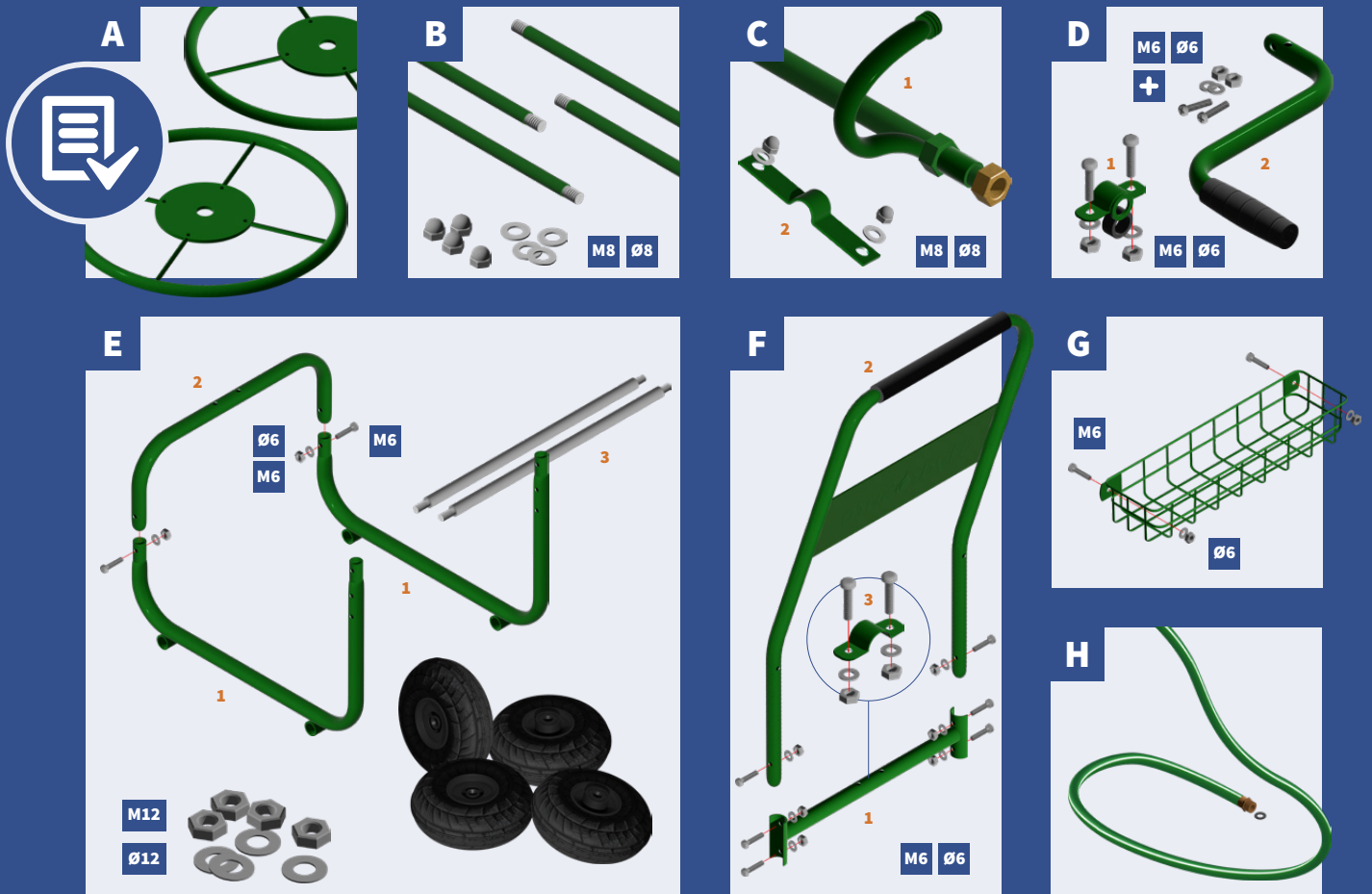

ASSEMBLY INSTRUCTIONS



Tools Required



Adjustable Spanner

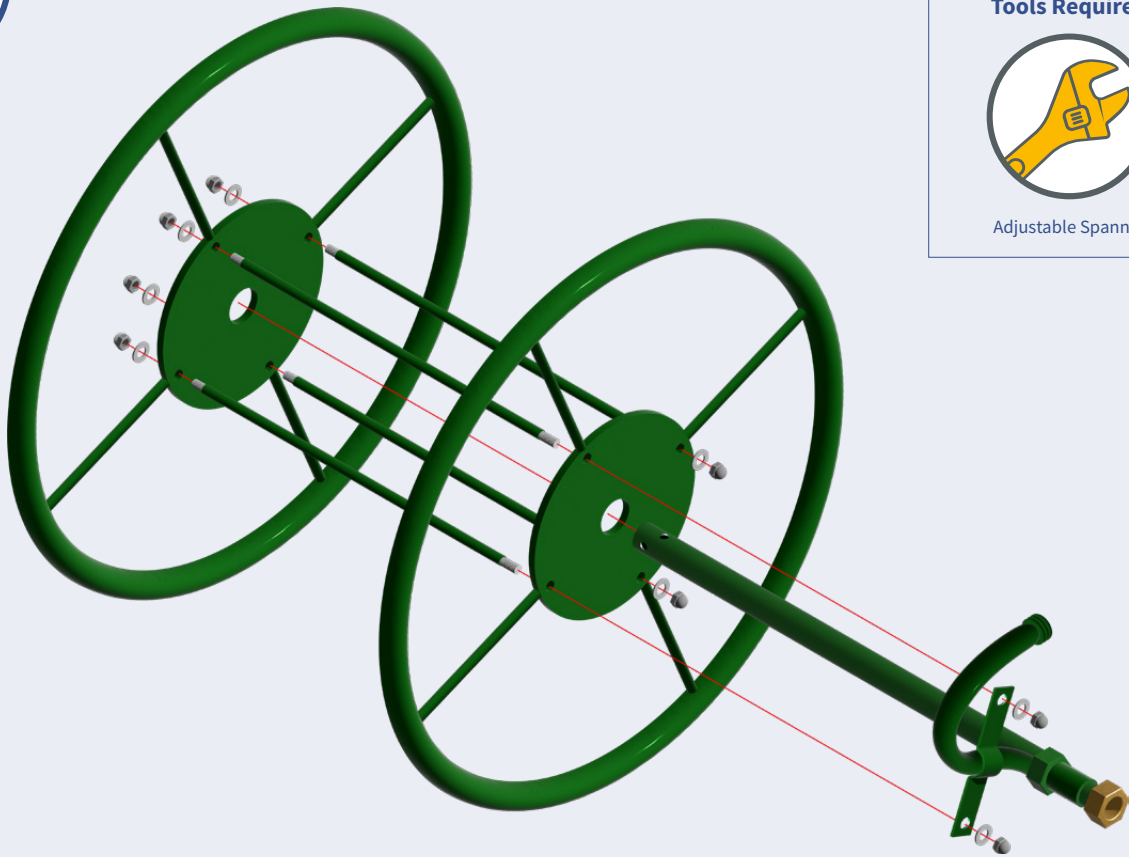

Insert the ends of four Rods (B) into one Spool (A) and secure with $\varnothing 8$ Washers and M8 Nuts. Insert the opposite ends of the four Rods (B) into the remaining Spool (A) and secure just two of the Rods with $\varnothing 8$ Washers and M8 Nuts, leaving two adjacent ends open.

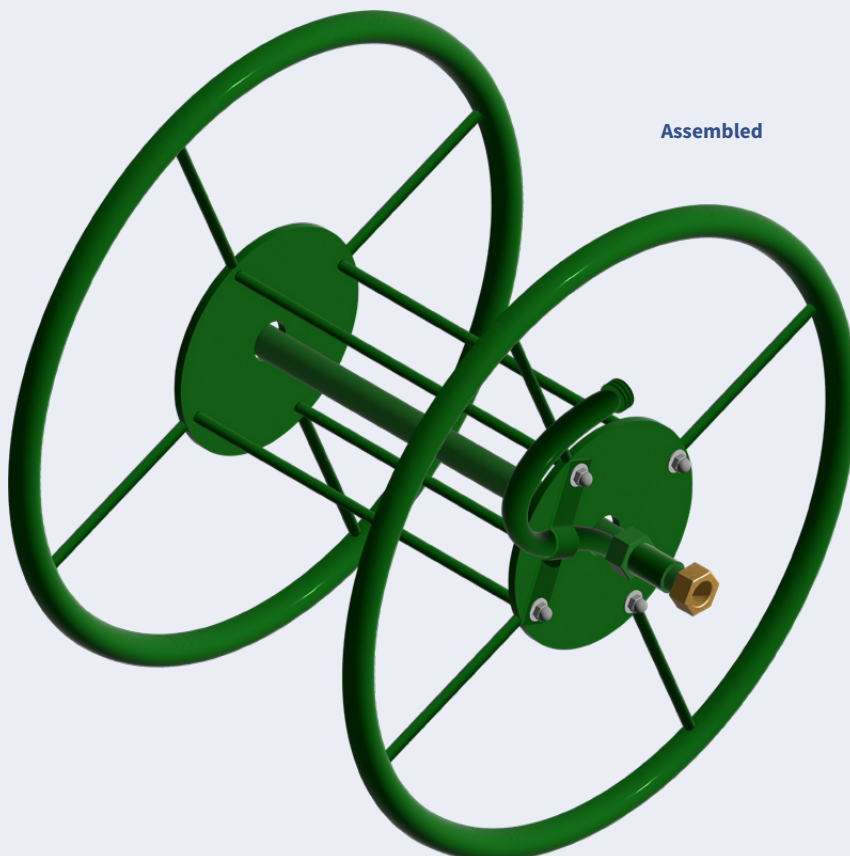

Assembled

A

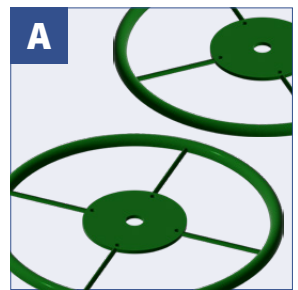

B

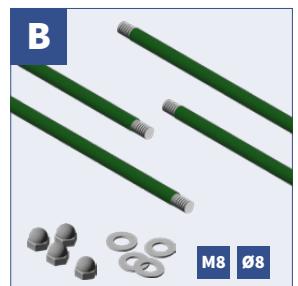

C

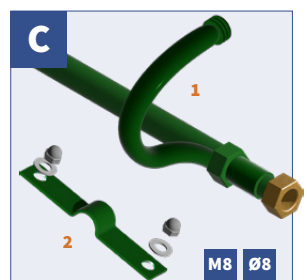

Slide the Axle Shaft (C1) through the centre holes of both Spools (A), ensuring that the angle hose section of the Axle Shaft (C2) is centred between the two unsecured rods. Place Clip (C2) over the Angle Hose and secure it to the Rods with $\varnothing 8$ Washers & M8 Nuts.

ASSEMBLY INSTRUCTIONS

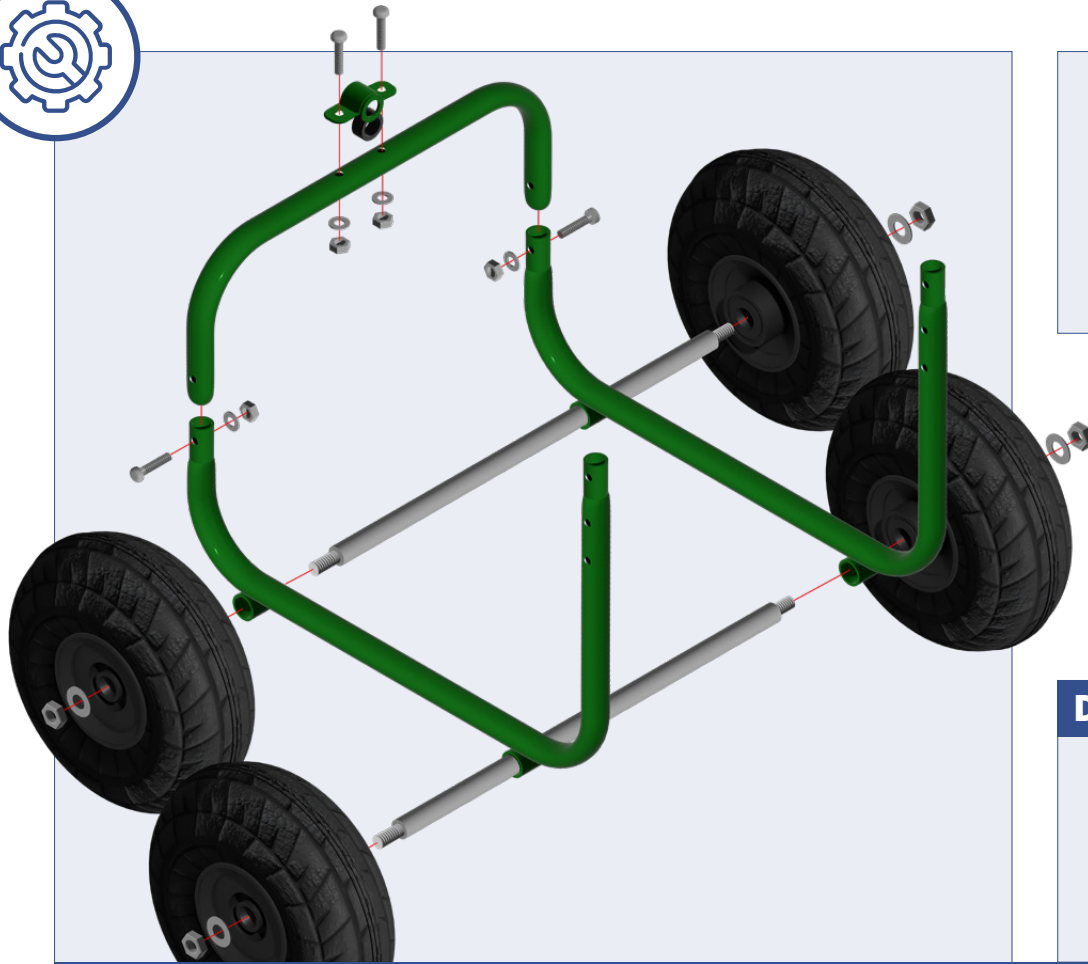

Tools Required



Adjustable Spanner

D

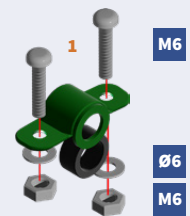

Slide two Axles (E3) into the holes of both Axle Bracket Frames (E1) and attach a Wheel to the end of each Axle. Secure the wheels with Ø12 Washers & M12 Nuts. Slot the U-Shape Frame (E2) onto the short end of the Axle Bracket Frame (E1) and secure with M6 Bolts, Ø6 Washers & M6 Nuts.

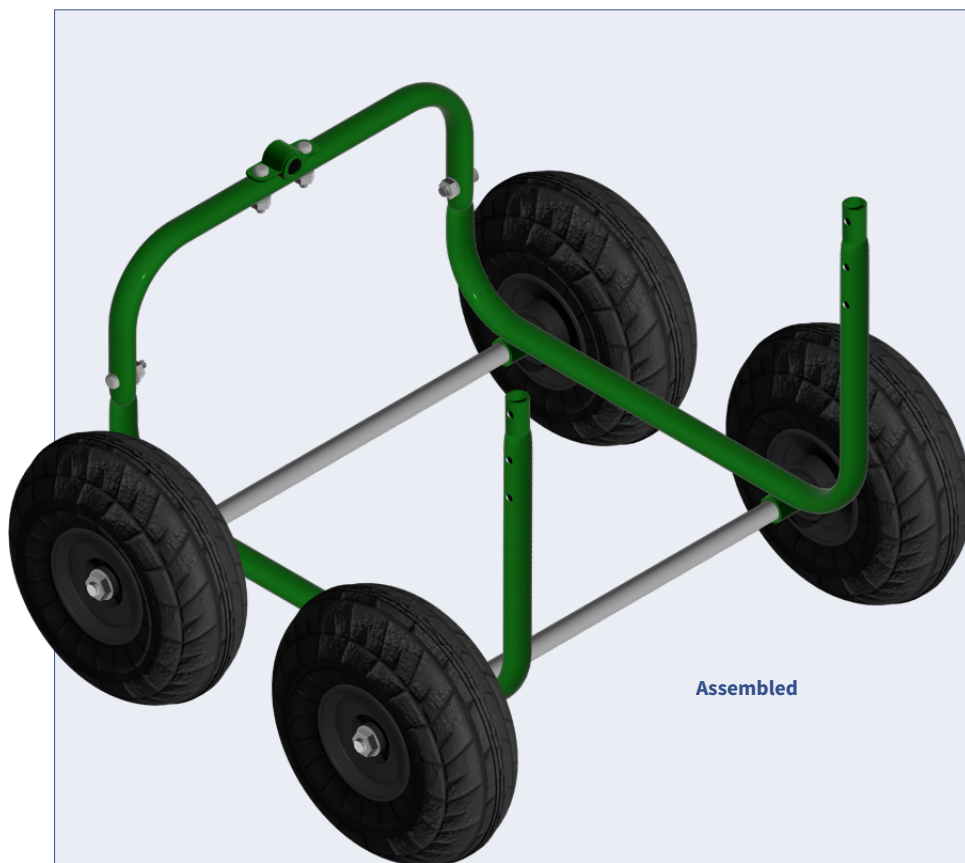

Assembled

E

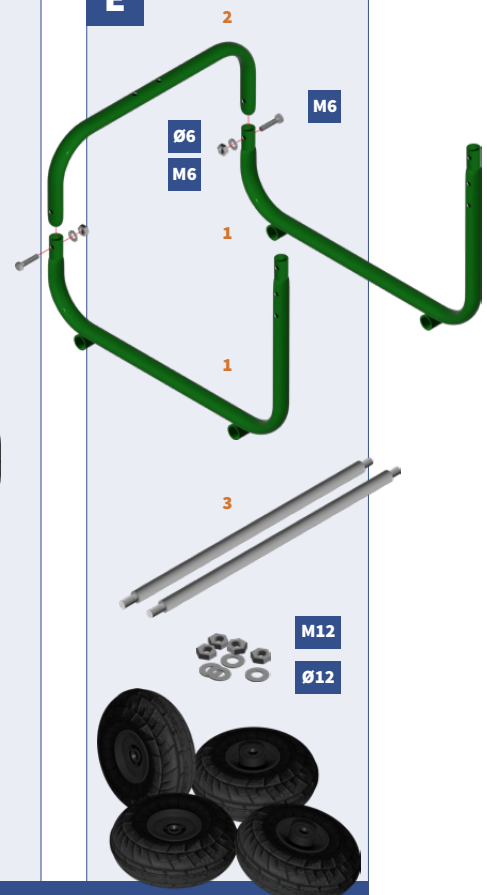

Attach Bearing Bracket (D1) to U-Shape Frame (E2) and secure with M6 Bolts, Ø6 Washers and M6 Nuts.

ASSEMBLY INSTRUCTIONS

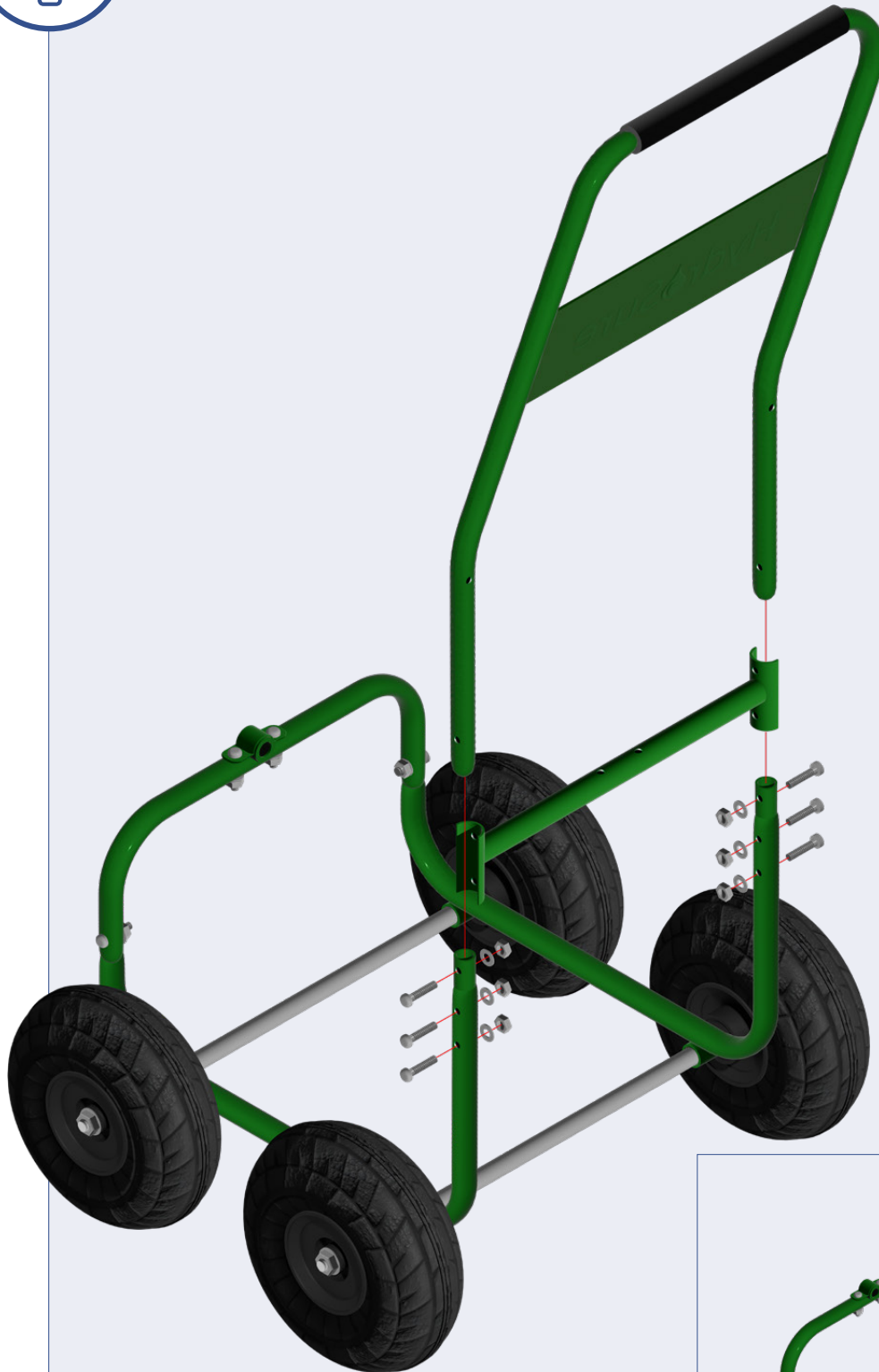

Tools Required



Adjustable Spanner

F

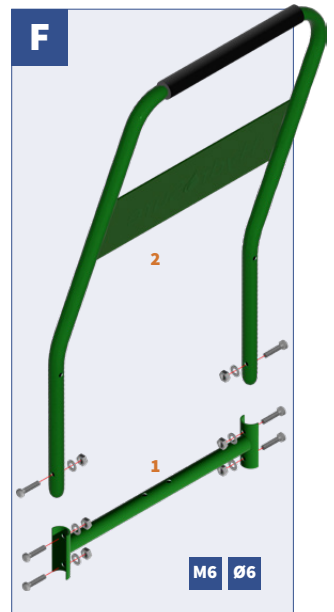

M6 Ø6

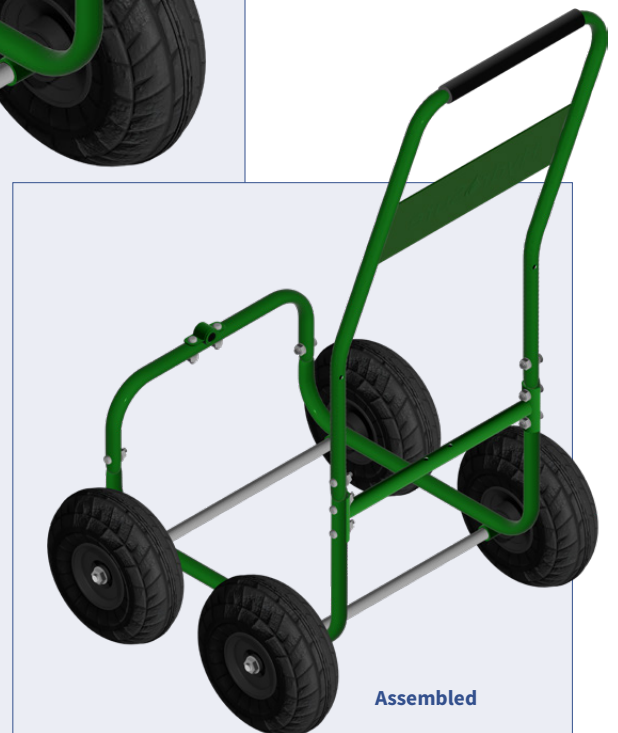

Assembled

Attach the I-Shape Brace (F1) to the long end of the Axle Bracket Frame (E1) and secure with M6 Bolts, Ø6 Washers & M6 Nuts.
Slot the Pull Handle (F2) onto the long end of the Axle Bracket Frame (E1) and secure with M6 Bolts, Ø6 Washers & M6 Nuts.

ASSEMBLY INSTRUCTIONS

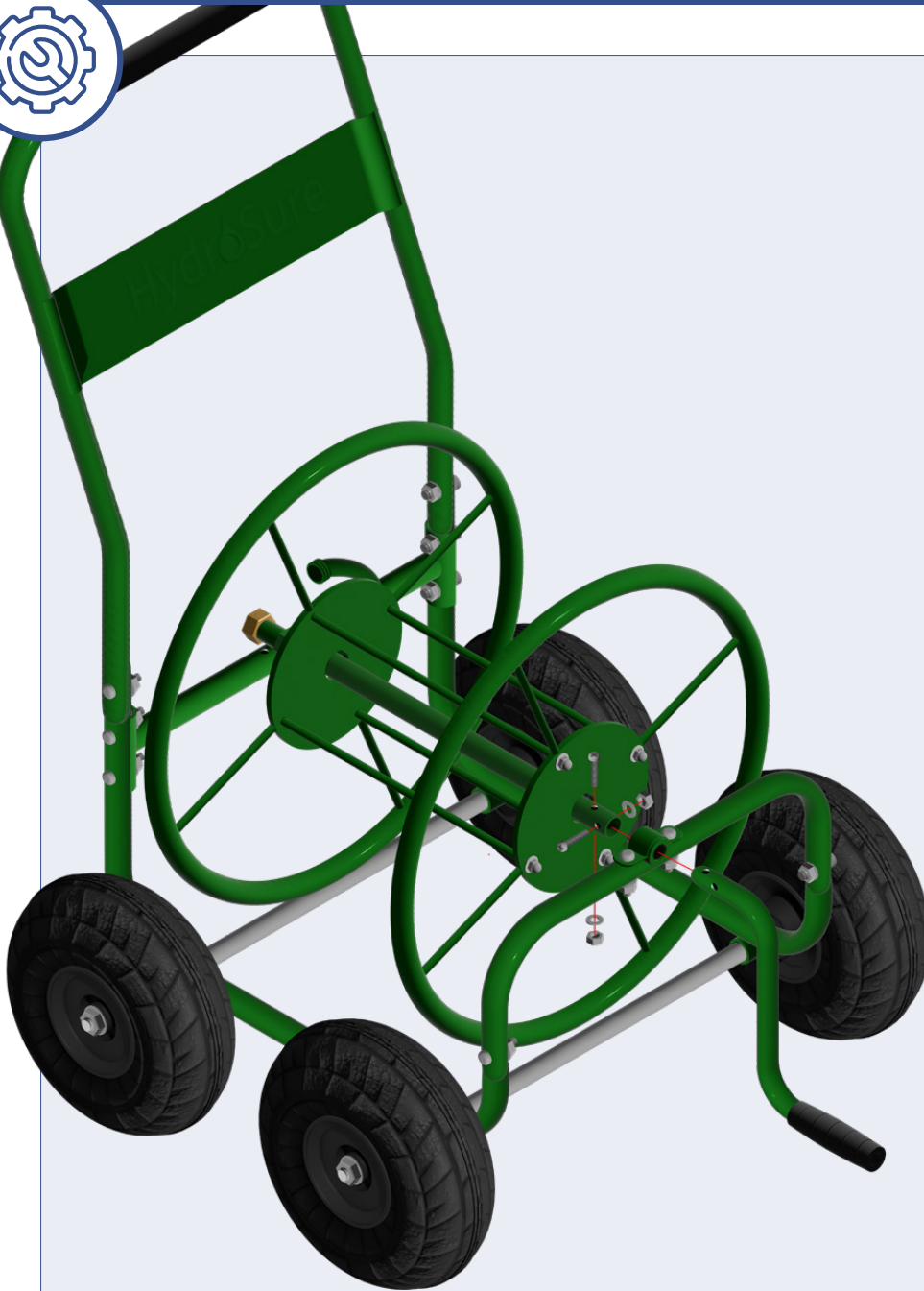

Tools Required



Adjustable Spanner &
Cross Head Screwdriver

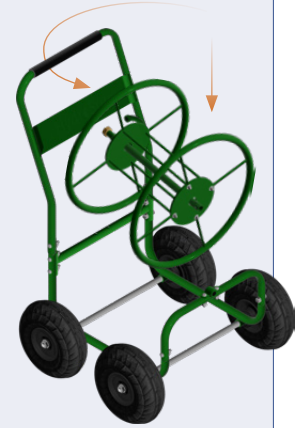

Lower the Spool Assembly
into the Trolley

D

M6 Ø6
+



Slide the Handle (D2) through the Bearing Bracket (D1), then directly into the Axle Shaft on the Spool.
Attach the Handle to the Axle Shaft using a M6 Screws, Ø6 Washers and M6 Nuts.

ASSEMBLY INSTRUCTIONS

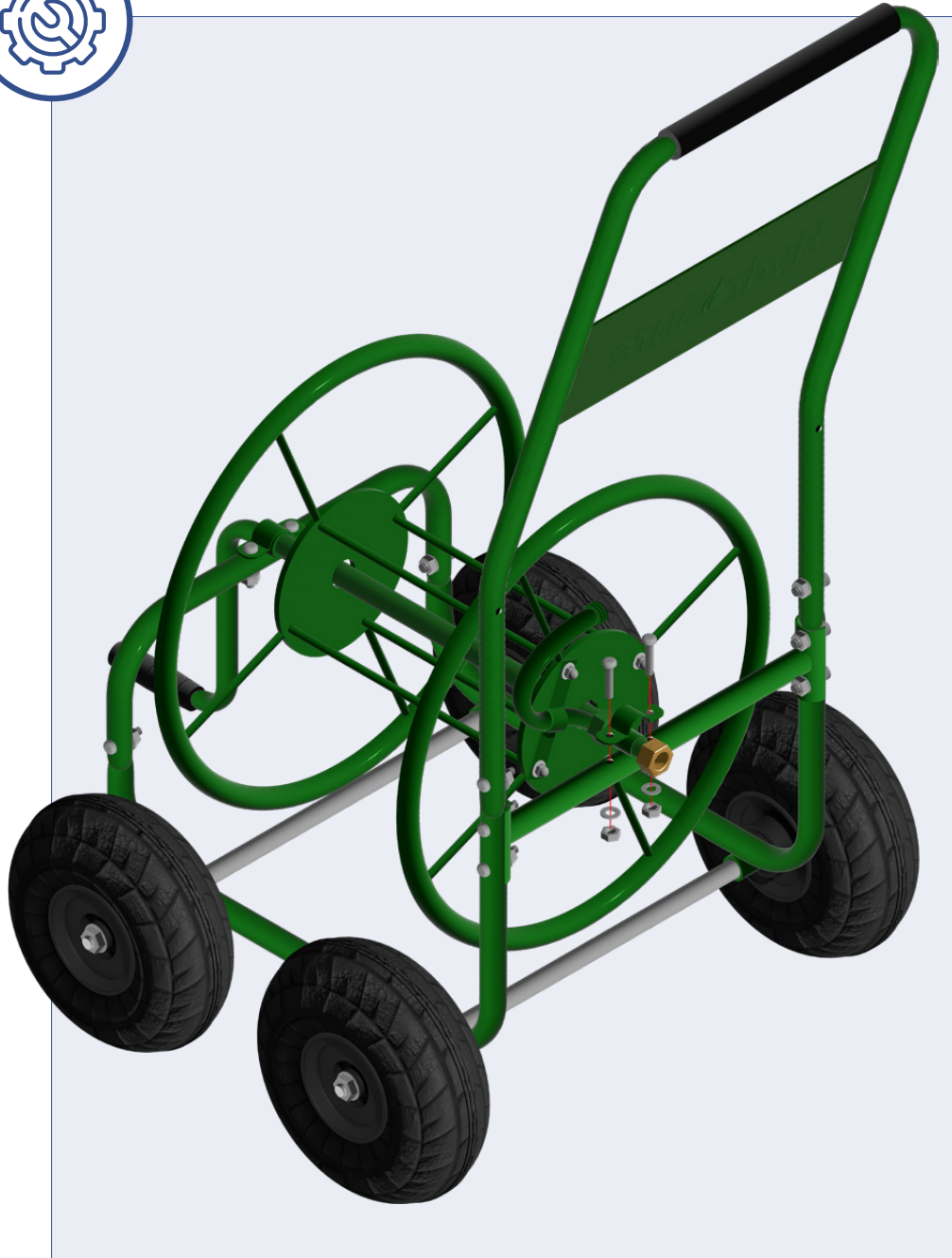

Tools Required



Adjustable Spanner

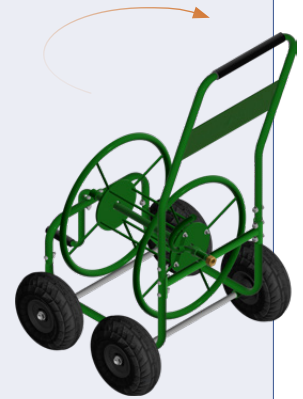

Moving to the Pull Handle Side of the Trolley

F

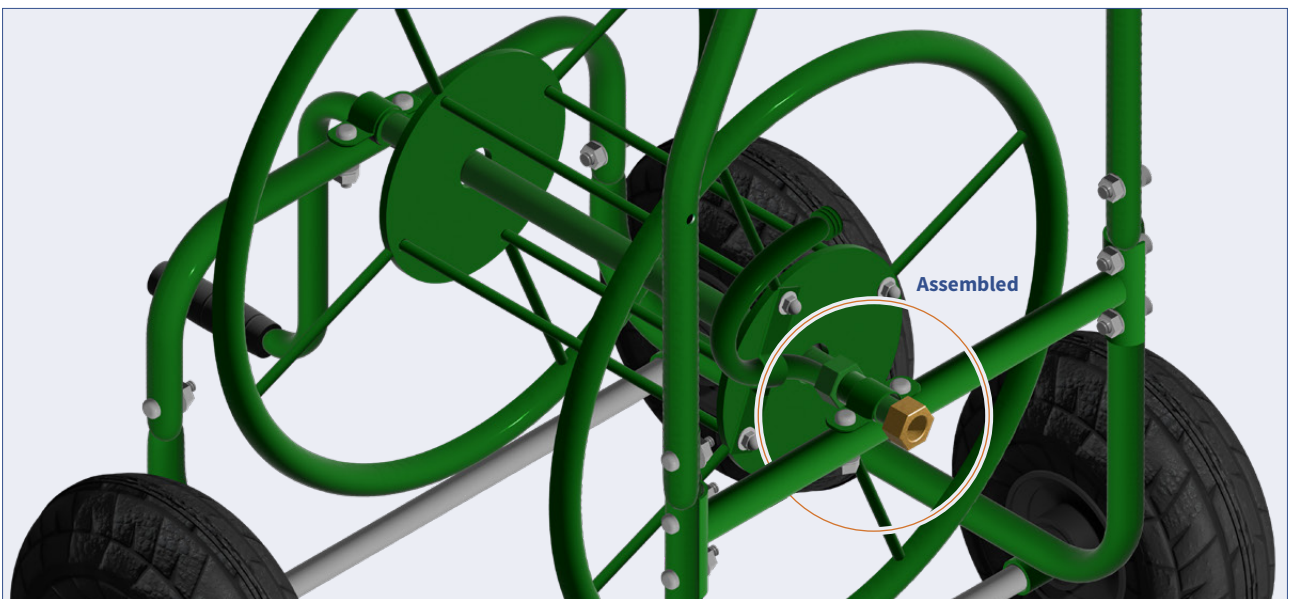
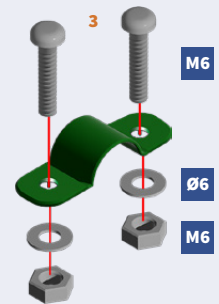

Put the Axle Shaft on top of the I-Shape Brace. Place Bracket (F3) in line with the two holes on the I-Shape Brace. Attach using M6 Bolts, Ø6 Washers and M6 Nuts.

ASSEMBLY INSTRUCTIONS

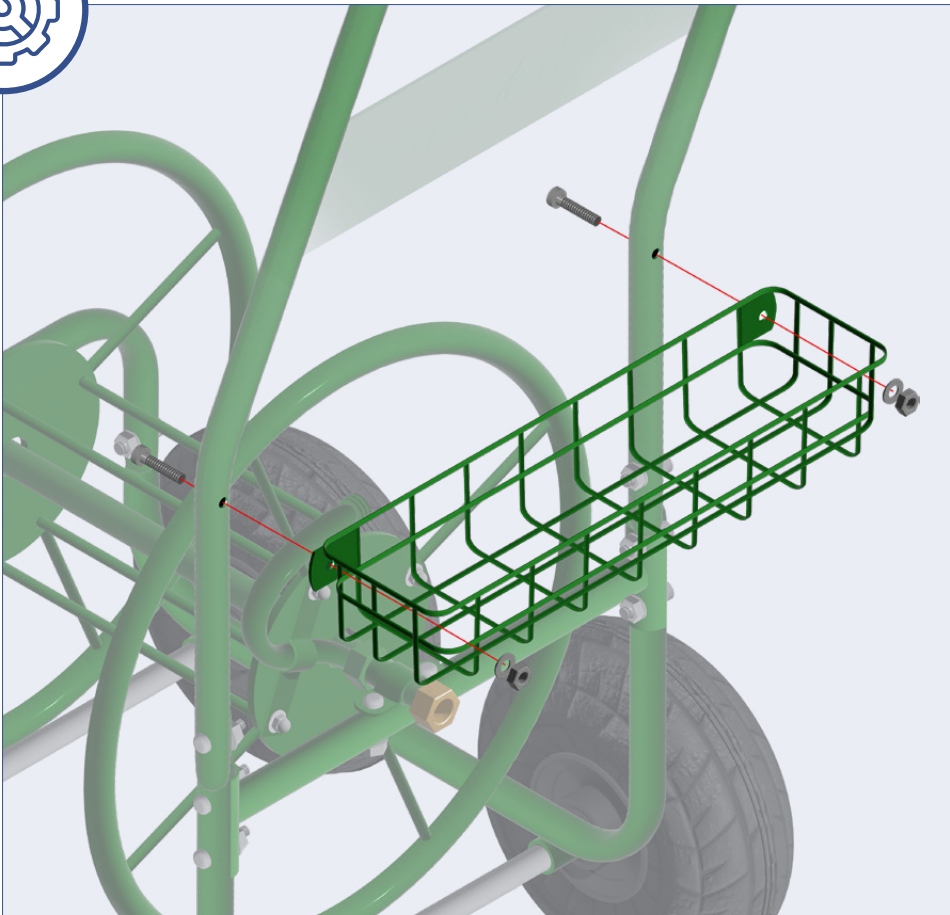

Tools Required



Adjustable Spanner

G

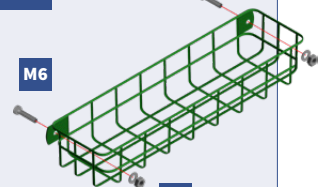

H

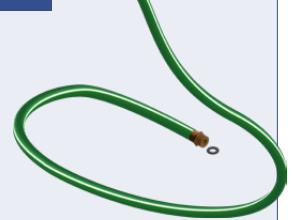

Attach the Mesh Basket (G) to the Pull Handle directly above the I-Shape Brace and secure with M6 Bolts, Ø6 Washers and M6 Nuts.

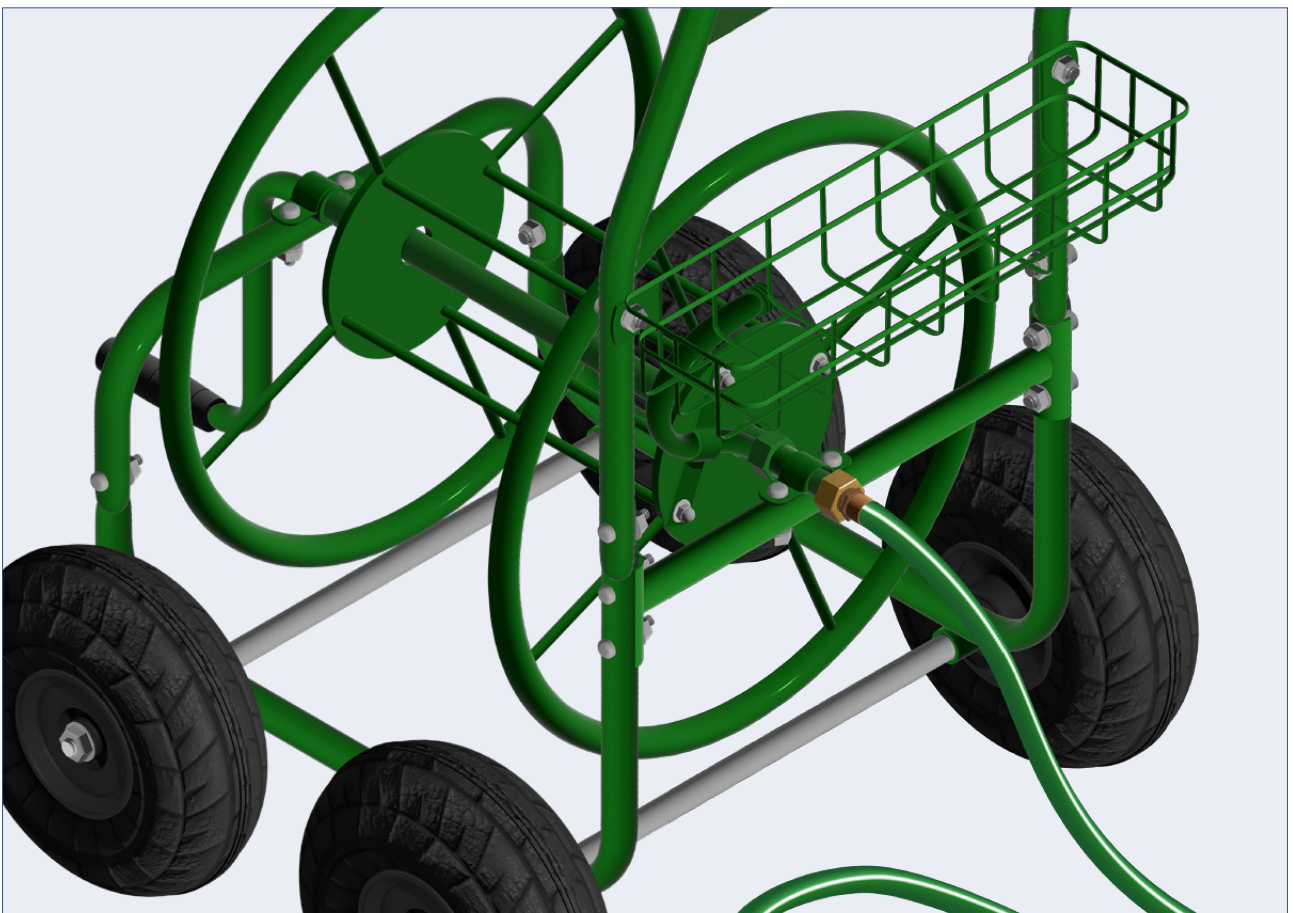

Attach Leader Hose (H) to the Axle Shaft directly below the Mesh Basket (G).
Do not overtighten.

150M HEAVY DUTY HOSE REEL CART WITH BASKET

COMPLETE ASSEMBLY

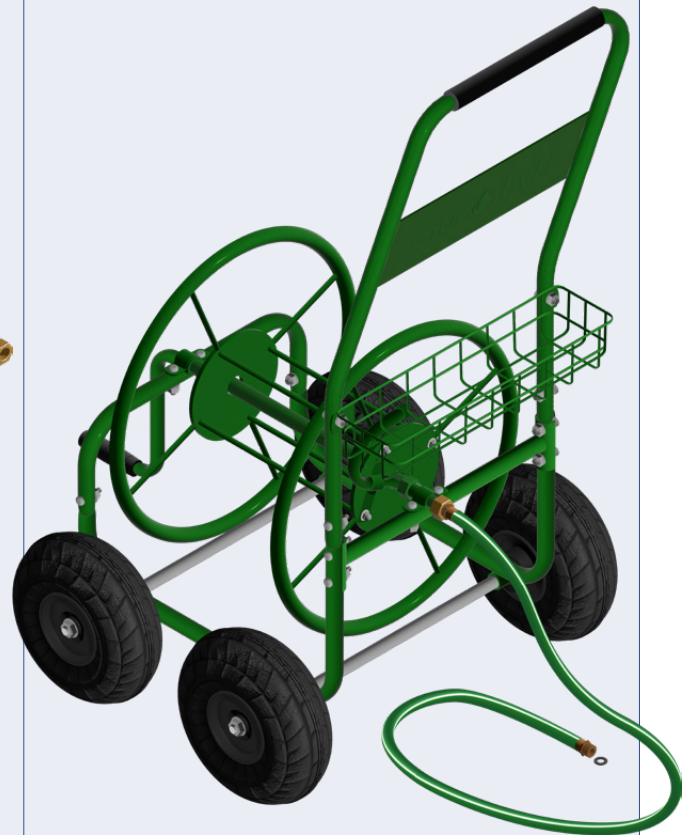
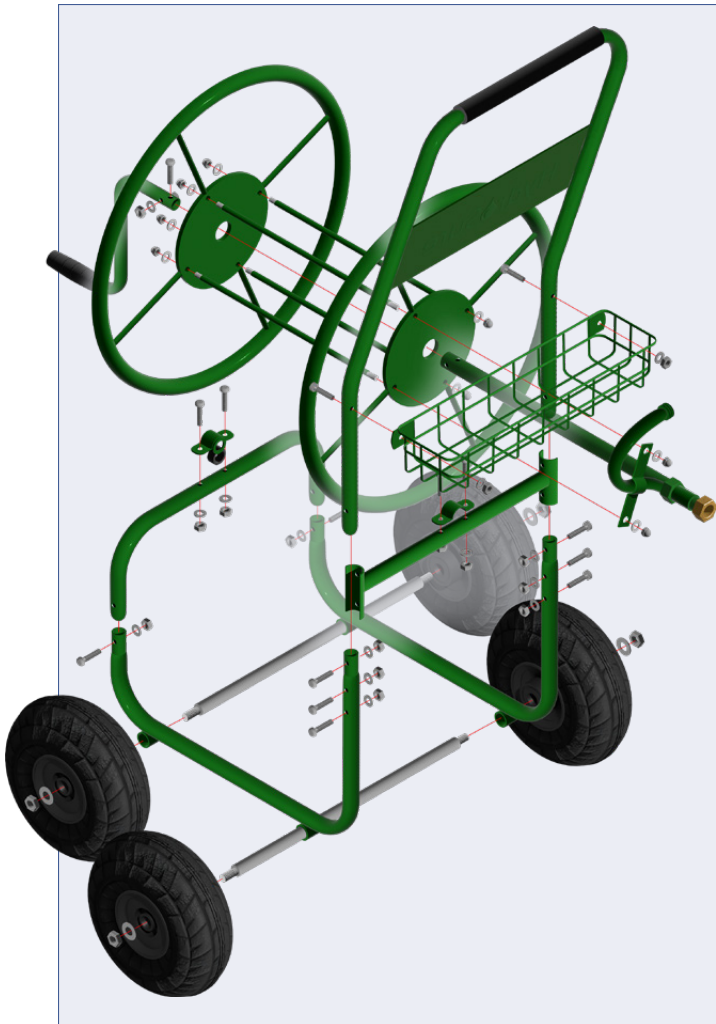

ADDITIONAL EQUIPMENT

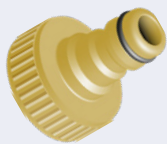

ADDITIONAL EQUIPMENT

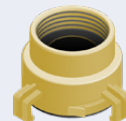
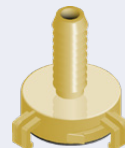

ADDITIONAL EQUIPMENT

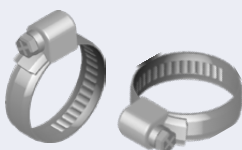

HydroSure™

IRRIGATION SYSTEMS THAT WORK

www.hydrosure.com

